



QSM-1550 AM

Multi-jet, Vane wheel,
Dry-dial, Cold(Hot) Water Meter



Application:

--Measuring the total volume of cold portable water passing through the pipeline.

Feature:

- Multi-jet, dry-dial, easy for maintenance;
- Magnetic drive reliable characteristic, long working life;
- Vacuum sealed register ensures the dial keep free from fog and frost, Keep the reading clear in a long term service;
- Technical data conform to international standard ISO4064 Class B

Working condition:

Water temperature: 0.1 °C ~40 °C for cold water meter .

0.1 °C ~90 °C for hot water meter.

Water pressure : $\leq 1.0\text{Mpa}$ or 1.6Mpa

Maximum permissible error:

(1) in the lower zone from q_{\min} inclusive up to but excluding q_t is $\pm 5\%$.

(2) in the upper zone from q_t inclusive up to and including q_s is $\pm 2\%$;

Hot water meter $\pm 3\%$

MAIN TECHNICAL SPECIFICATIONS

Type	Size (mm)	Class	q_s Overload Flow	q_p Permanent Flow	q_t Transitional Flow	q_{\min} Minimum Flow	Minimum Reading	Maximum Reading
			m^3/h		L/h		m^3	
QSM-15	15	B	3	1.5	120	30	0.00005	99,999
QSM-20	20	B	5	2.5	200	50	0.00005	99,999
QSM-25	25	B	7	3.5	280.0	70	0.00005	99,999
QSM-32	32	B	12	6.0	480	120	0.00005	99,999
QSM-40	40	B	20	10	800	200	0.00005	99,999
QSM-50	50	B	30	15	3000	450	0.00005	99,999



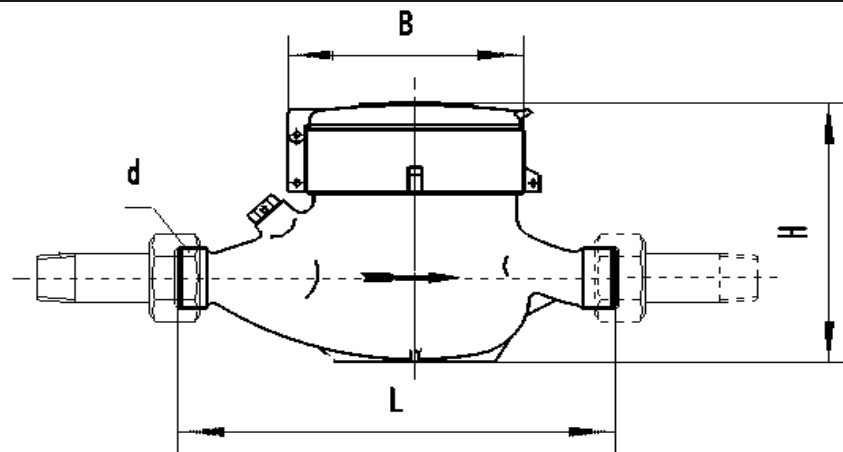

DIMENSIONS

Type	Size	L	B	H	d Connecting Thread
		Length	Width	Height	
mm					
QSM-15	15	165	98	116	G3/4B
QSM-20	20	190	98	117	G1B
QSM-25	25	260	103.5	124	G1 ¹ / ₄ B
QSM-32	32	260	103.5	124	G1 ¹ / ₂ B
QSM-40	40	300	125	162	G2B
QSM-50	50	300	125	162	G2 ¹ / ₂ B
		280	160	187.5	Flange connect ISO 7005-2:1988 φ D=125

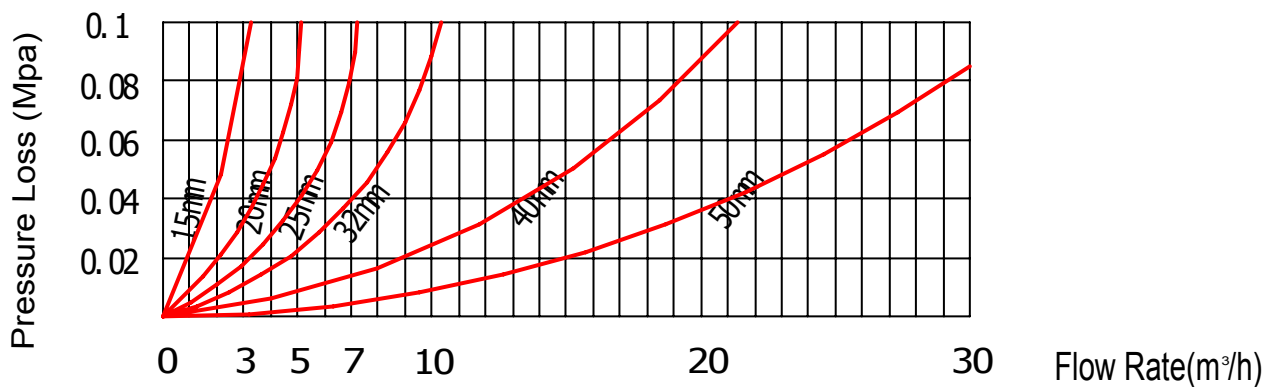

Flow Error Curve

